



MODEL:F-01-2BC-L

Description: The faucet is made of brass casting, grinding and polishing the surface after molding chrome plating, its scope of application: home kitchens, laboratories, centralized water supply points.

一. Constitution:

- (1)Parts: 1)Faucet*1; 2)Plate*1; 3)RubberWasher*2;
- 4)PiasticWasher*1; 5)StarWasher*1; 6)Locking Nut*1
- 7) 1/4" in-line Thread*1 8)Plastic Plug*1; 9) Compressing Plug*1;



二. Technical Parameters And Related Matters:

(1)Technical parameters:

Material		Weight (kg)	Type	Description	L(mm)	Norm. Pressure kg/cm2	Inlet Tube	Outlet Tube
Faucet	Knob	Faucet						
Cu	ABS	0.24	Ordinary goose neck faucet	chrome plated	75	2--3	1/4"	2/5"

(2)Installation diagram: (see photo)

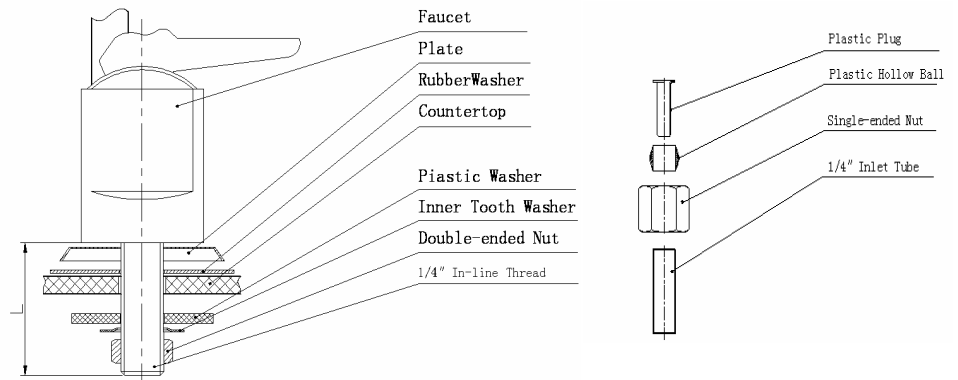

(3)Parts Size:

1)Plate:

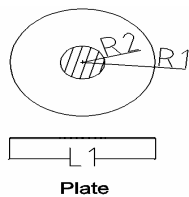

2)PiasticWasher

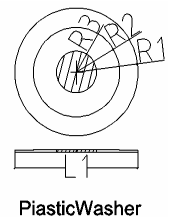

Name	Material	L1 (mm)	R1 (mm)	R2 (mm)
Plate	PVC	450	225	70

Name	Material	R1 (mm)	R2 (mm)	R3 (mm)
PiasticWasher	PVC	215	151	70

3)StarWasher:



Name	Material	R (mm)
StarWasher	CS	100

4)RubberWasher:

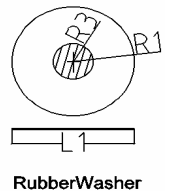

Name	Material	L1 (mm)	R1 (mm)	R2 (mm)
RubberWasher	NBR	430	215	70

(4)Packing:

Quantity of each package	N. W (Kg)	G. W (Kg)	L (mm)	W (mm)	H (mm)
50	12	15	50	32	37

Warning: Do not place in direct sunlight component.



MODEL: F-01-3BC-L 3/8"

Description: The faucet is made of brass casting, grinding and polishing the surface after molding chrome plating, its scope of application: home kitchens, laboratories, centralized water supply points.

—. Consti tuti on:

- (1)Parts: 1)Faucet*1; 2)Plate*1; 3)RubberWasher*2;
- 4)PiasticWasher*1; 5)StarWasher*1; 6)Locking Nut*1
- 7) 1/4" in-line Thread*1 8)3/8"connector *1; 9) Lock Nut*1;



二. Technical Parameters And Related Matters:

(1)Technical parameters:

Material		Weight (kg)	Type	Description	L(mm)	Norm. Pressure kg/cm2	Inlet Tube	Outlet Tube
Faucet	Knob	Faucet						
Cu	ABS	0.24	Ordinary goose neck faucet	White	75	2--3	3/8"	2/5"

(2)Installation diagram: (see photo)

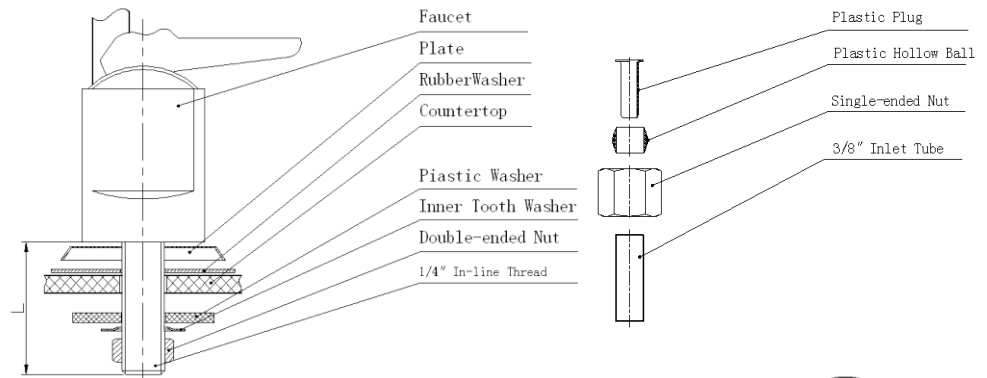

(3)Parts Size:

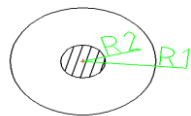

1)Plate:

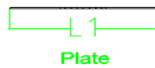

Name	Material	L1(mm)	R1(mm)	R2(mm)
Plate	PVC	450	225	70

2)PiasticWasher

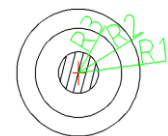

Name	Material	R1(mm)	R2(mm)	R3(mm)
PiasticWasher	PVC	215	151	70

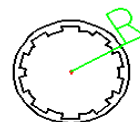

3)StarWasher:

StarWasher

Name	Material	R(mm)
StarWasher	CS	100

4)RubberWasher:

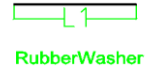
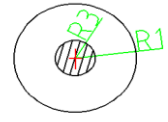

Name	Material	L1(mm)	R1(mm)	R2(mm)
RubberWasher	NBR	430	215	70

(4)Packing:

Quantity of each package	N.W(Kg)	G.W(Kg)	L(mm)	W(mm)	H(mm)
50	12	15	50	32	37

Warning: Do not place in direct sunlight component.